

# THAVZALL

Tamarack Industries



## E-XHR100 Parts Manual



CONFORMS TO UL STD 1278  
CERTIFIED TO CSA STD C22.2#46

As a new customer of Tamarack we would like to welcome you! We are looking forward to providing you with technical support for your Thawzall unit. Whatever you need we are here to help.

## **Ways to contact us for support**

### **By Phone : 1-800-661-0304**

The main Technical support phone line is staffed monday-friday 7:00 AM to 3:30 PM excluding holidays.

### **After hours support**

Calls received outside of regular hours are directed to the On-call technician. After hours support is reserved for issues that cannot wait until the next business day for resolution. If no answer please leave a message and we will get back to you as soon as possible.

### **By Email : [support@tamarack-ind.com](mailto:support@tamarack-ind.com)**

Feel free to email us at any time with technical questions or parts inquiries. Please include the year make and model of your unit if you have a specific question about your machine so we can better help you. If it is an emergency please call 1-800-661-0304

For more information please visit our website

**[www.thawzall.com](http://www.thawzall.com)**

# Table of contents

<b>Title</b>	<b>Pages</b>
Ways to contact Us	1
Enclosure	3-4
Control Panel Door	5-6
Accessory Panel Door	7-8
Frame	9-10
Heater-Fan Assembly	11-12
Decals	13-15
Electrical	16-18
Schematics	19-20

# ENCLOSURE

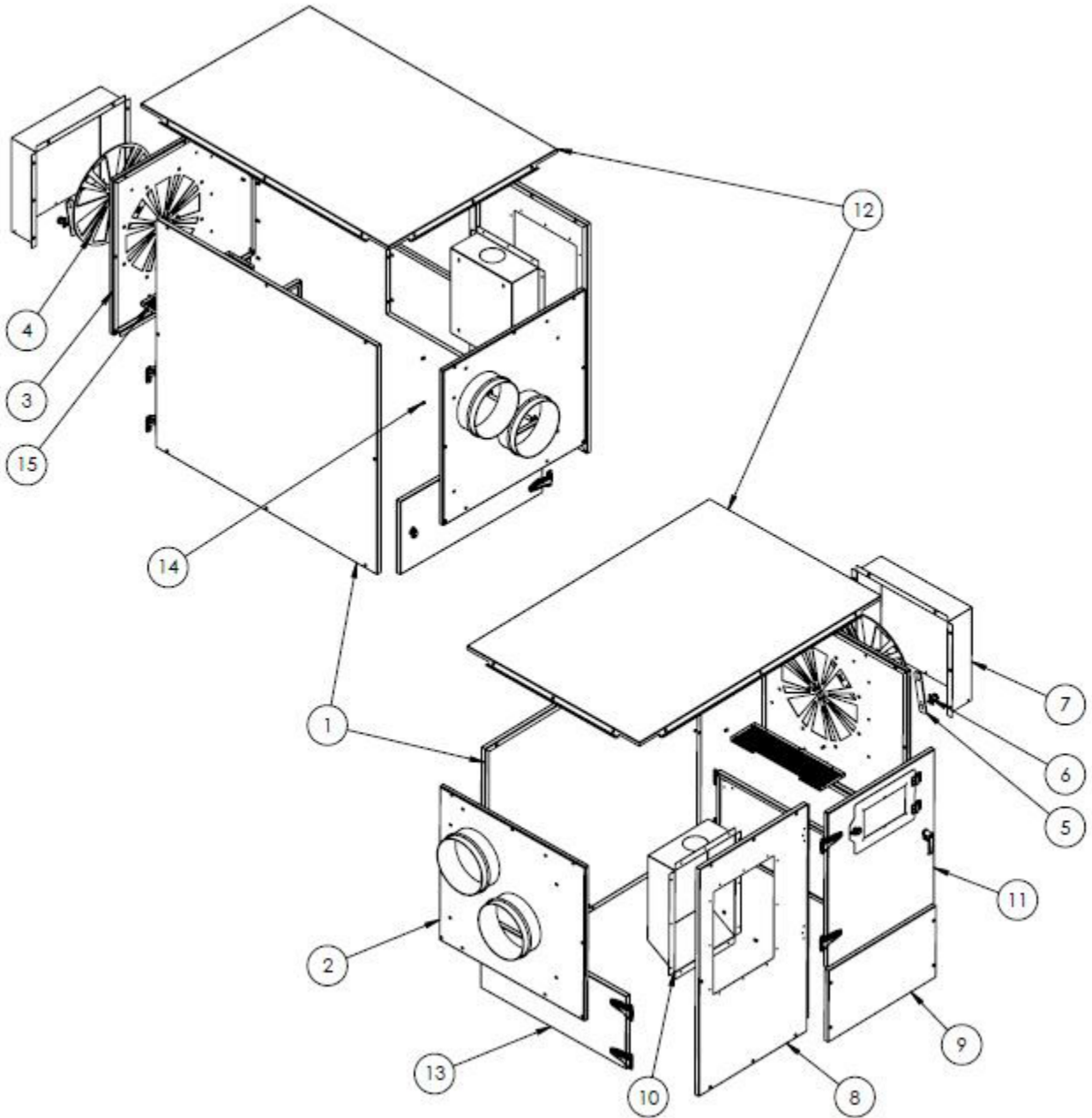
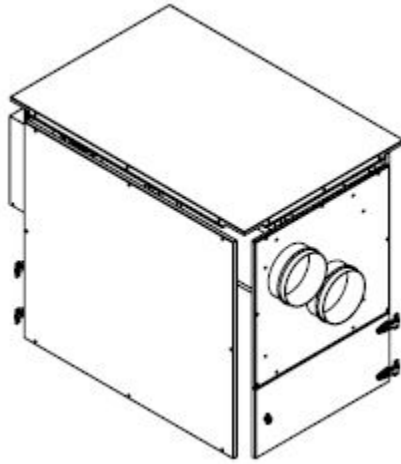

15	601071	PNL, INLET AIR SHROUD E-XHR
14	447728	RIVNUT, 1/4 UNC x 0.02 -0.08
13	A601050	ASSY,STORAGE ACC. DOOR EXHR
12	601027	PNL, ROOF EXHR
11	A601042	ASSY, CTRL PANEL DOOR FLMS
10	601028	BKT, POWER BOX MNT.EXHR
9	601040	PNL, SIDE LWR EXHR
8	601039	PNL, SIDE REAR EXHR
7	601033	PNL, FAN INLET HOOD
6	600933	PLUNGER,PLATE-MNT RETRACT.
5	601034	PNL,AIR GATE LEVER
4	A600875	ASSY,WA,FAN INLET BAFFLE MOVABLE
3	601026	PNL, FAN MOUNT EXHR
2	A601046	ASSY,WA,OUTLET DUCT EXHR
1	601023	PNL, SIDE EXHR
ITEM NO.	PART NUMBER	DESCRIPTION

# CONTROL PANEL DOOR

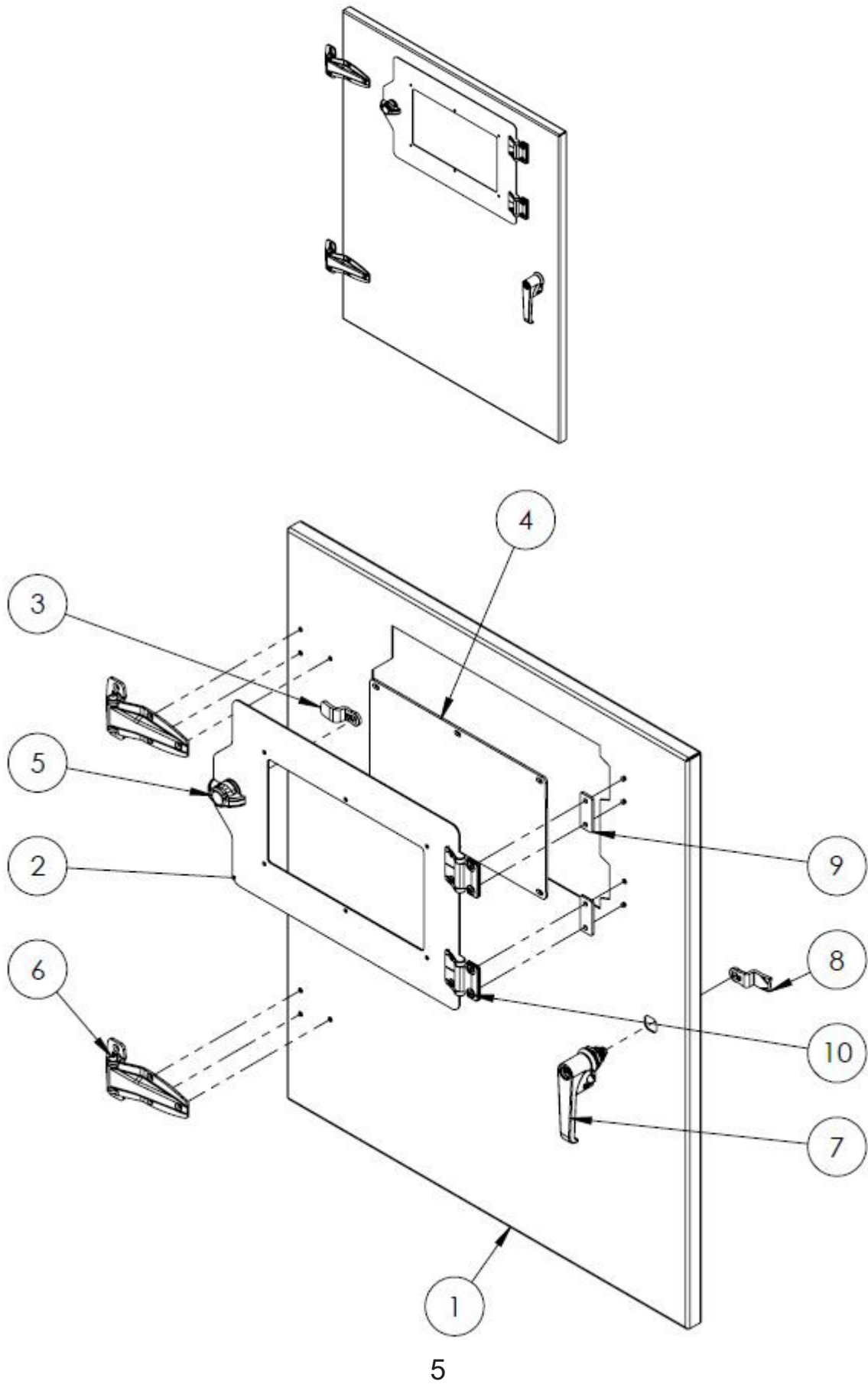

10	461545	HINGE,E6-10-400-50
9	601062	PNL, HINGE SPACER CTRL
8	601045	CAM LATCH 29.5MM GRIP SPEP
7	601044	HANDLE, LATCH W/PADLOCK DIE CAST
6	500069	HINGE,STRAP
5	600166	LOCK,PADLOCKABLE W/ HANDLE
4	600168	SCREEN,CLEAR X750
3	600167	CAM,LATCH 6MM GRIP
2	600471	PNL,OPERATING CTRL XHR
1	601043	PNL, CONTRL PANEL DOOR OUTER
ITEM NO.	PART NUMBER	DESCRIPTION

# ACCESSORY DOOR

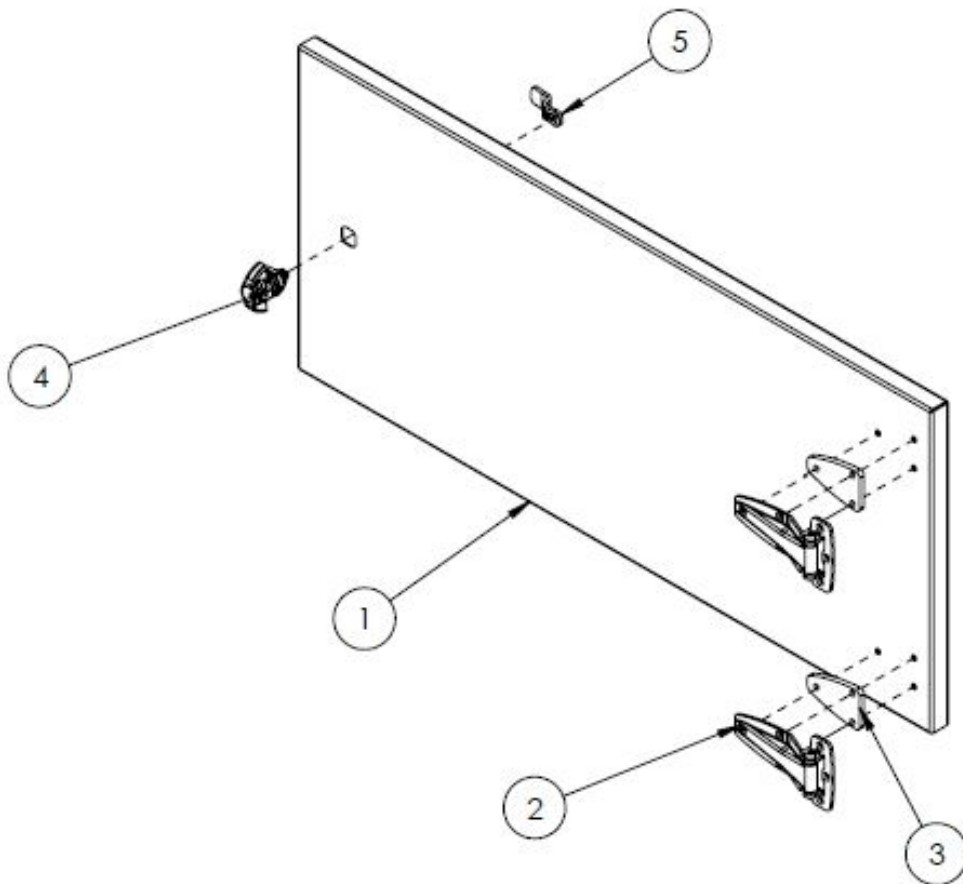
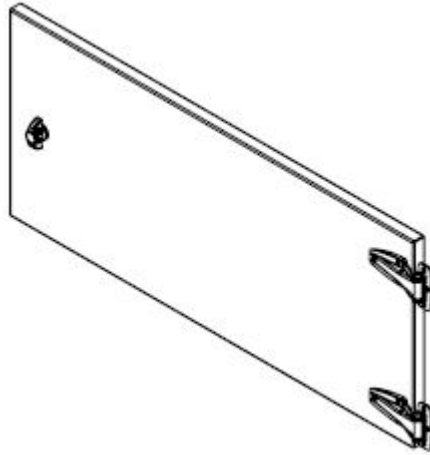



5	601128	CAM, LATCH 30MM GRIP
4	600166	LOCK,PADLOCKABLE W/ HANDLE
3	601051	BKT,DOOR HINGE SPACER
2	500069	HINGE,STRAP
1	601029	PNL, SIDE BOTTOM DOOR
ITEM NO.	PART NUMBER	DESCRIPTION

# FRAME

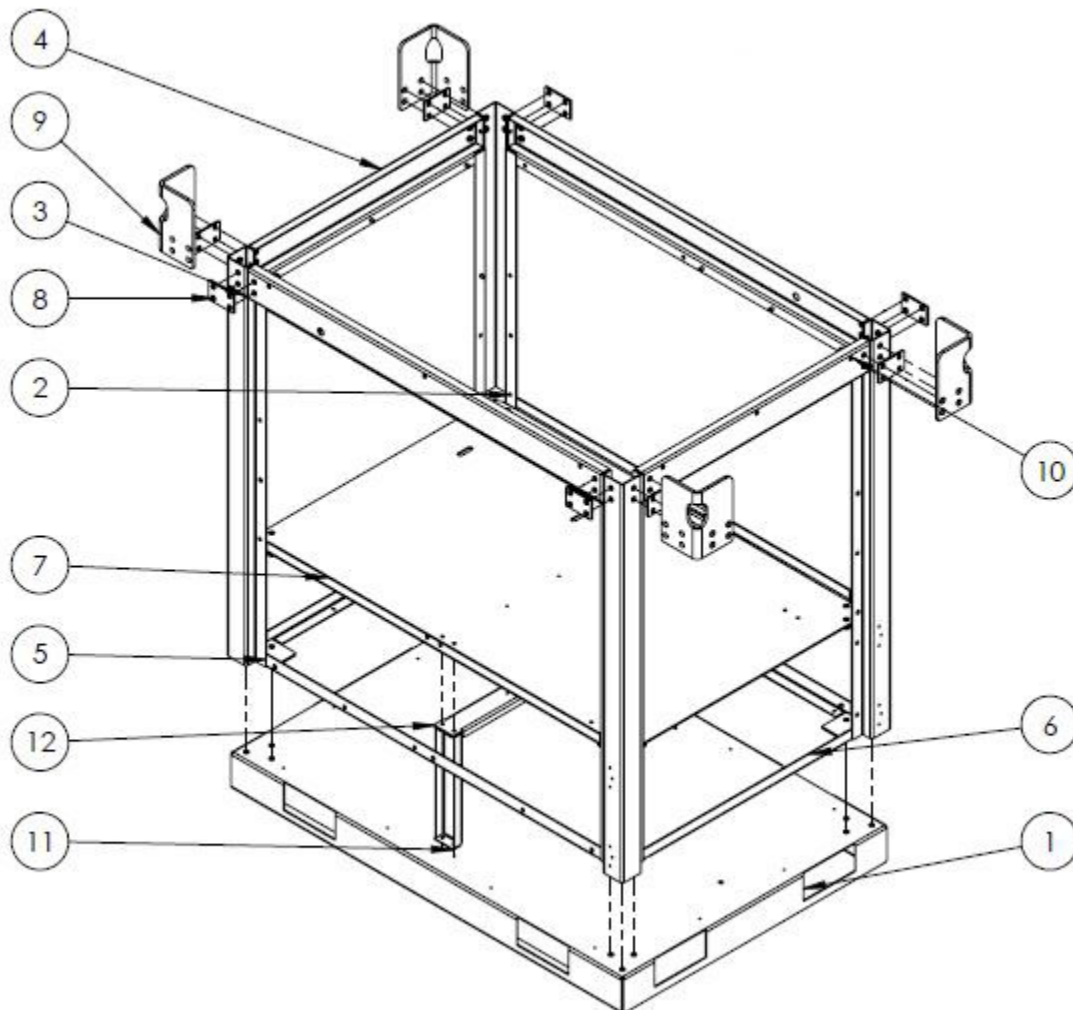
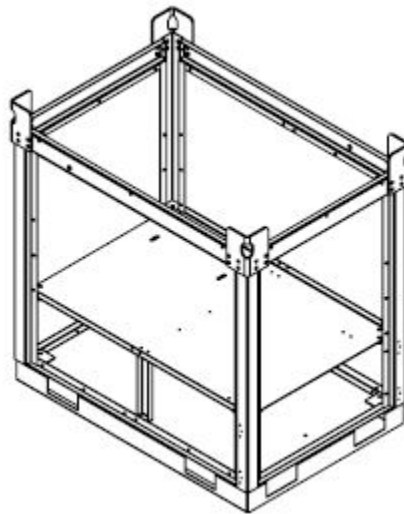

12	601061	PNL, BRACE CROSS EFLMS
11	601059	BKT,MIDDLE STIFFNER SUPPORT
10	447728	RIVNUT, 1/4 UNC x 0.02 -0.08
9	601011	BKT,LIFTING EXHR
8	601036	PNL, SPACER LIFTING HOOK
7	601017	BKT,MID FLOOR EXHR
6	601019	BKT,FRONT REST EXHR
5	601018	BKT,SIDE REST EXHR
4	601022	PNL, FRONT-REAR TOP EXHR
3	601021	PNL, SIDE TOP EXHR
2	A601015	ASSY,WA,CORNER POST EXHR
1	601014	BKT,BASE FLOOR EXHR
ITEM NO.	PART NUMBER	DESCRIPTION

# HEATER-FAN ASSEMBLY

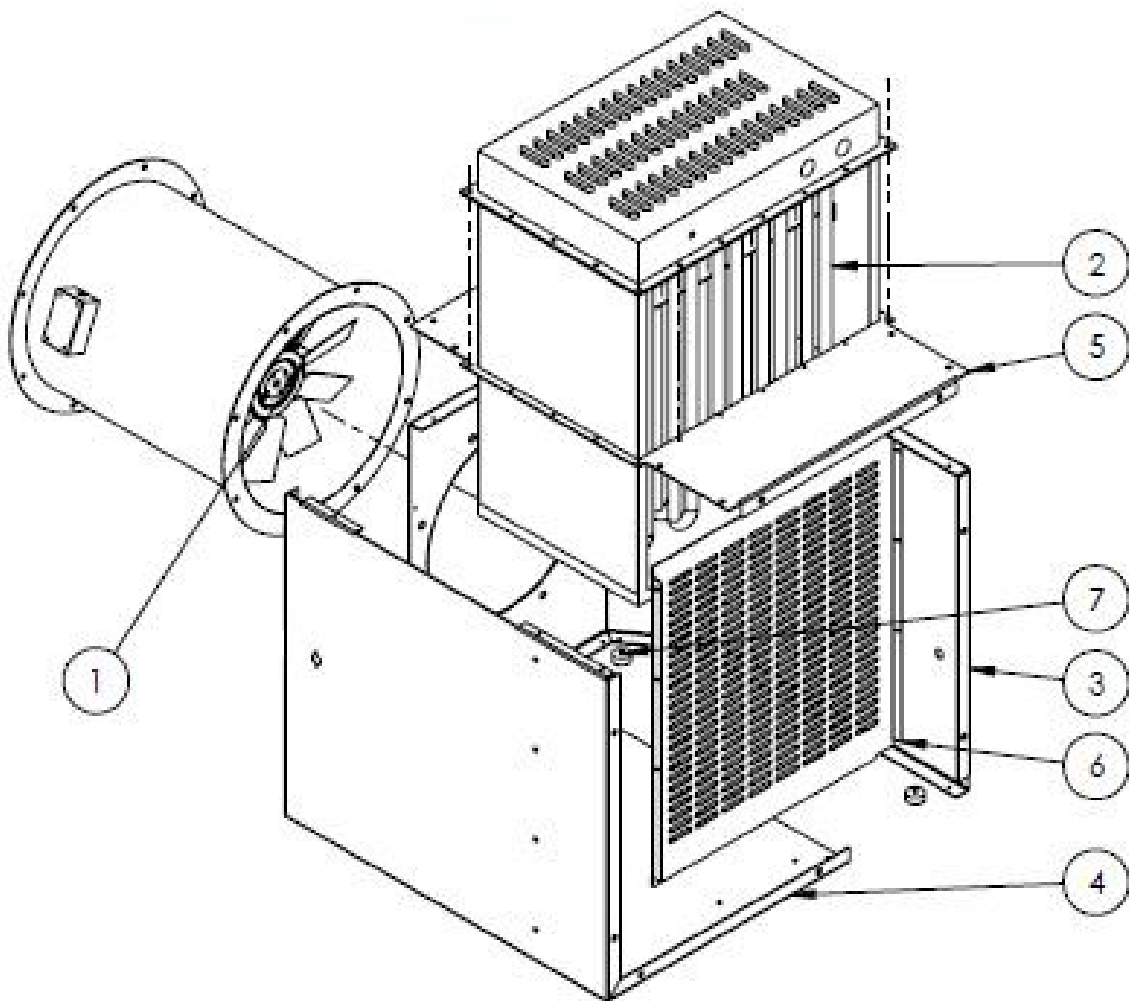
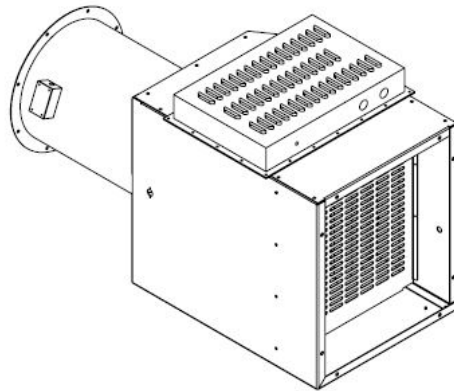

7	601058	Threaded-Stud Bumper
6	601035	PNL,REAR BLOCK EQ EXHR
5	601032	PNL, TOP HEAT DUCT EXHR
4	601030	PNL, BOTTOM HEAT DUCT EXHR
3	601031	PNL, LH SIDE HEAT DUCT EXHR
2	600895	HEATER BANK,DUCT SST 100KW3CRC
1	600813	FAN, TUBE AXIAL CONTINENTLE 18IN
ITEM NO.	PART NUMBER	DESCRIPTION

# DECALS

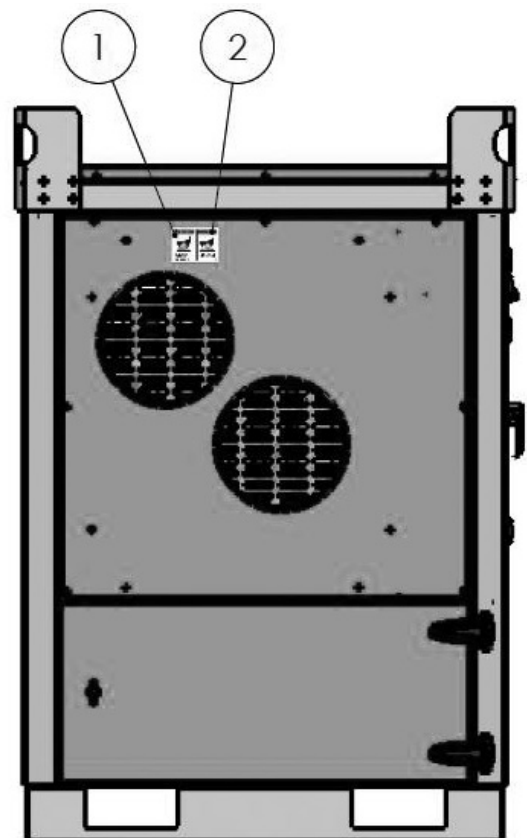
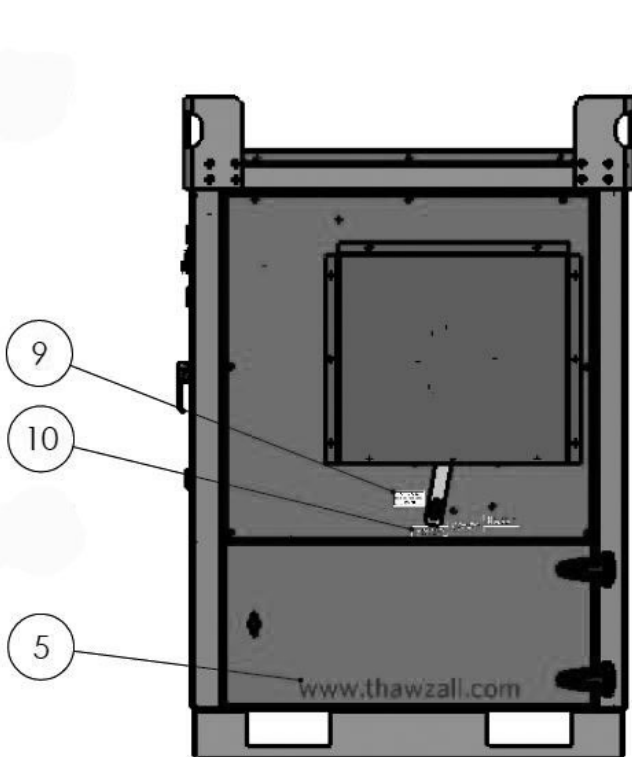
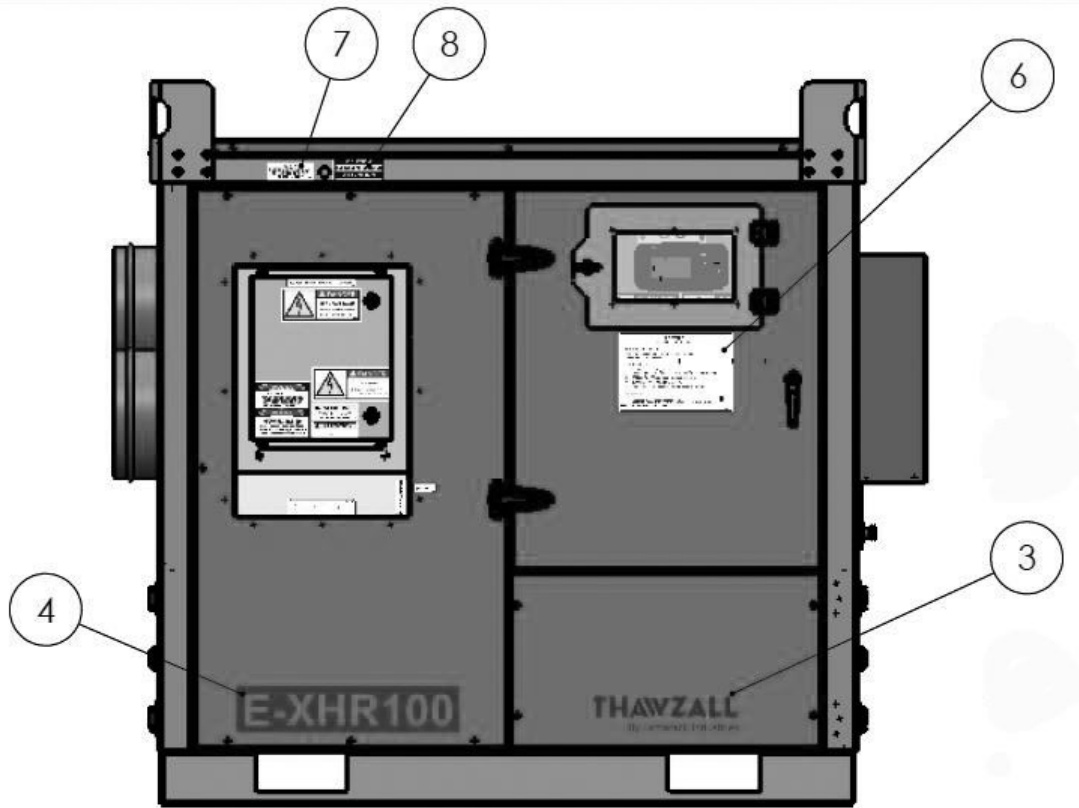

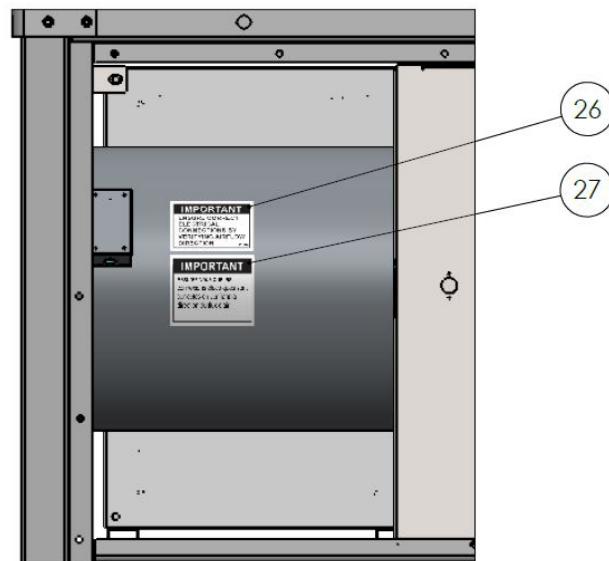
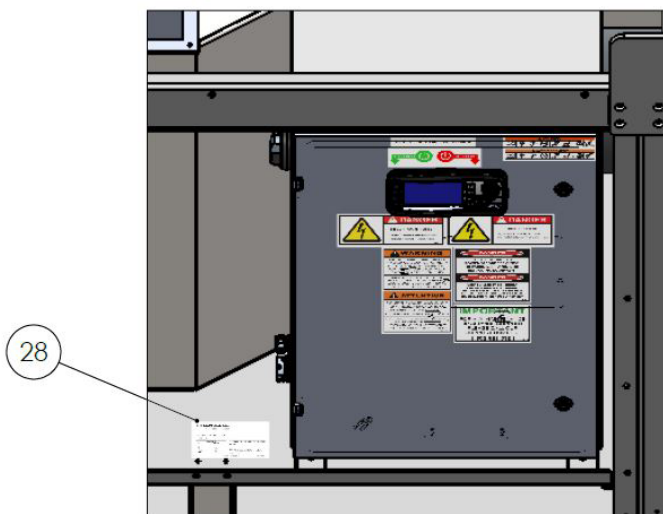
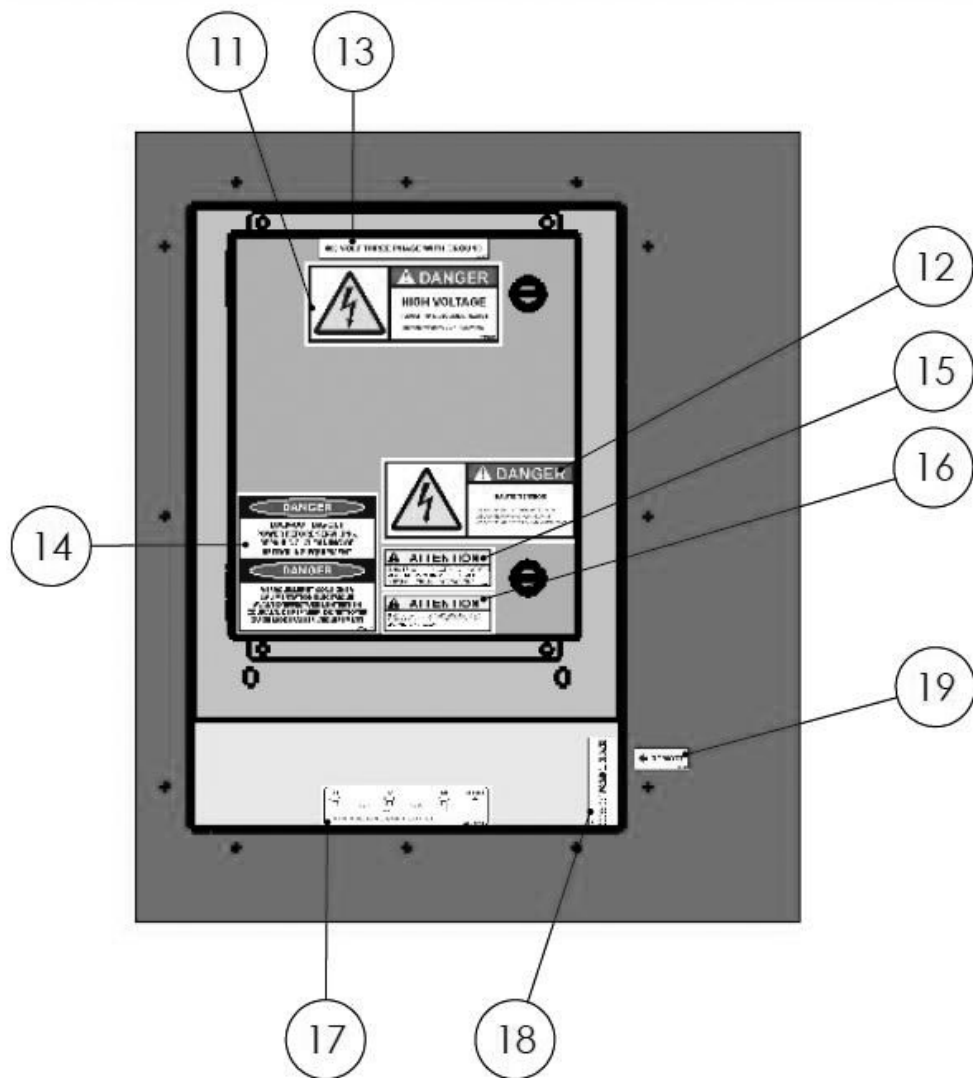

30	A800009	KIT,DECALS SUNBELT E-XHR	1
29	601183	MANUAL,OPERATING EXHR100	1
28	601063	PLATE, CSA E-XHR	1
27	601074	DECAL,CONNECTION VERF. FRENCH	1
26	601070	DECAL, CONNECTON VERIFICATION	1
25	201256	DECAL ,SERVICE CALL SUPPORT	1
24	600233	DECAL,WARNING OVERLOAD CRNT	1
23	201251	DECAL,FRENCH, WARNING ICONS	1
22	201237	DECAL, WARNING ICONS	1
21	600506	DECAL,START STOP HERE	1
20	601066	DECAL, 24V DC CONTROL POWER	1
19	601068	DECAL, REMOTE	1
18	601069	DECAL, REMOTE TEMP. PROBE	1
17	601075	DECAL, 3PH CONNECTION	1
16	601073	DECAL , POWER DISCONN. XHR FRE	1
15	600502	DECAL , POWER DISCONNECT XHR	1
14	600249	DECAL,LOCKOUT	2
13	601067	DEACL,480V 3P WITH GROUND	2
12	601072	DECAL,WARNING HIGH VOLTAGE FRE	2
11	700533	DECAL,WARNING HIGH VOLTAGE	2
10	601397	DECAL, GATE POSITION STRIP	1
9	601396	DECAL, AIR GATE ADJ. LEVER	1
8	600235	DECAL,E STOP ENG/FRENCH	1
7	600507	DECAL,EMERGENCY STOP ONLY	1
6	601064	DECAL,OPERATING INST. E-XHR	1
5	500189	DECAL,THAWZALL WEBSITE	1
4	601165	DECAL,E XHR-100 GREY	1
3	601166	DECAL,THAWZALL BY TAM SML-GRY	1
2	201253	DECAL,FRENCH, HOT SURFACE	4
1	201023	DECAL, WARNING HOT SURFACE	4
ITEM NO.	PART NUMBER	DESCRIPTION	QTY.



# ELECTRICAL COMPONENTS

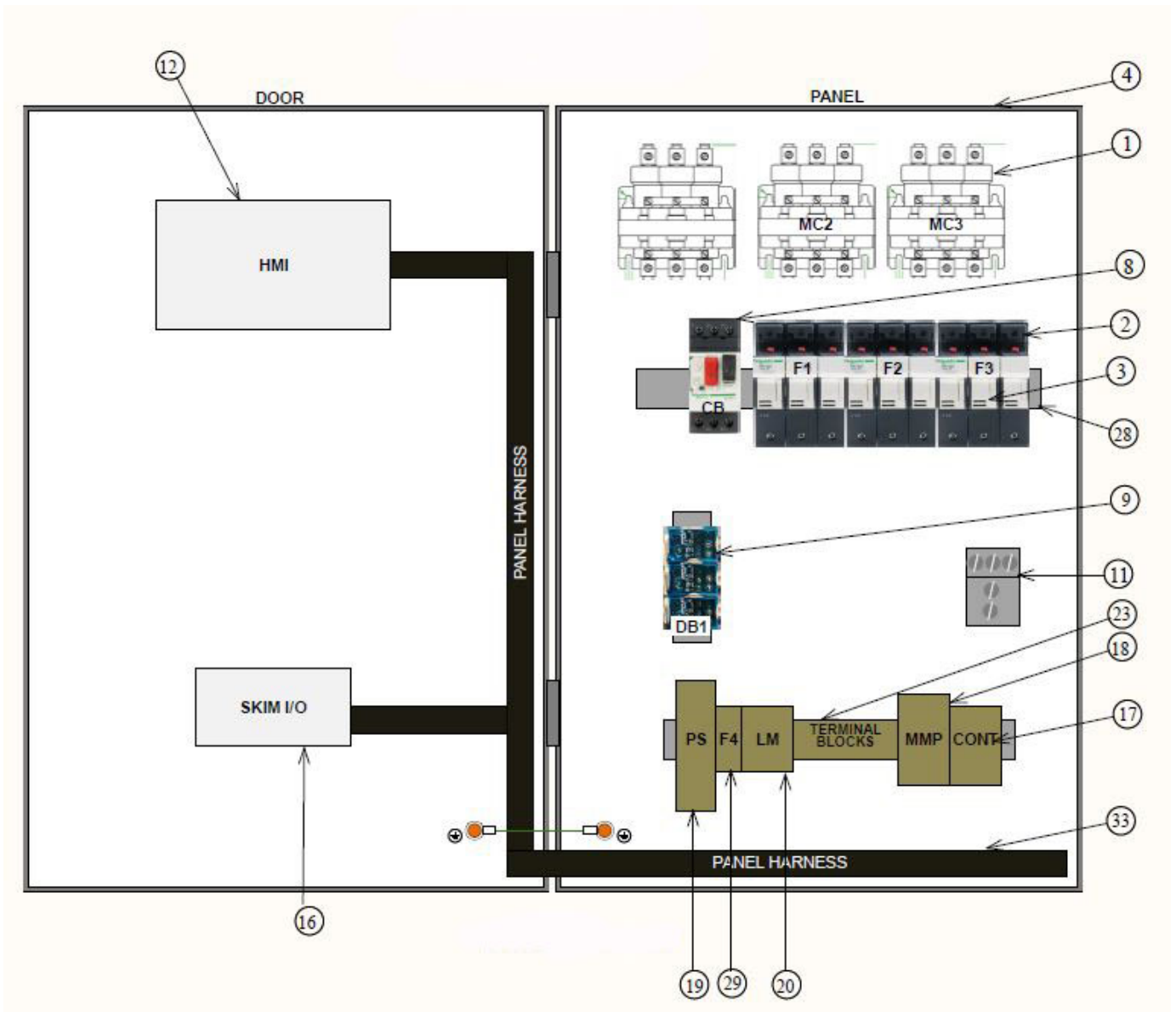

S No.	PART #	DESCRIPTION	QTY
1	E700424	RELAY, 3P, 60A2480V-24VDC MERC	3
2	E700425	FUSE CARRIER, 3P 50A 690V	3
3	E700426	FUSE CARTRIDGE 50A 700AC	9
4	E700429	PANEL BOX, 30" X 20" X 8"	1
5	446527	SWITCH, STOP PUSH-PULL A-B	1
6	446528	LATCH, MOUNTING A-B	1
7	446529	CONTACT, BLOCK NC A-B	1
8	446495	CIRCUIT BREAKER, THERMAL MOTOR	1
9	E700430	DISTRIBUTION BLOCK, 1P 125AIEC	3
10	E461791	CABLE, M12, 4PIN, 7M, FEMALE	1
11	E700436	LUG TERMINAL, 1/0-14AWG	2
12	E700437	HMI PROGRAMMED EXHR	1
13	E700438	PANEL MOUNT, HMI OPUSA3	1
14	E700439	SPACER, A3 12 GA BLACK	1
15	E700440	KIT, HMI FASTNERS	1
16	E700441	MODULE, SKIM8 PROGRAMMED EXHR	1
17	E700446	CONTACTOR, 12A 3P 24DC MOTOR	1
18	E700447	CIRCUIT BREAKER, 6.3- 10A 3P	1
19	600574	POWERSUPPLY, 5AMP 3PH 24DC	1
20	600559	MONITOR, 3-PHASE INLINE	1
21	E700442	SWITCH, TIP-OVER 12.5A 120VAC	1
22	E700432	WIRE, 6-1C STR BC FLEX 600V	15 MT
23	E461779	TERMINAL BLOCK, PT2, 5 GREY	24
24	E461180	TERMINAL BLOCK, JUMPER 10 POS	1
25	E461781	TERMINAL BLOCK, END COVER 2,5	2
26	E461782	TERMINAL BLOCK, MARKING PT2,5	0.3
27	446508	TERMINAL BLOCK, END COVER	5
28	446503	RAIL, DIN TS 35 X7.5 MM	0.92 MT
29	601171	CAGE,FUSE TERMINAL BLOCK	1
30	601170	FUSE, SLO BLO .25A -10A	1
31	600537	SENSOR, TEMPERATURE 250MM PROBE	1
32	600538	FITTING, COMPRESSION 1/2 NPTX6MM	1
33	E700443	HARNESS, EXHR PANEL	1
34	600521	BKT,AIR SENSOR MNT ALUM	1
35	468125	STRAIN RELIFE 3/8"	1
36	468124	NUT, PLASTIC STRAIN RELIEF 3/8"	1
37	X42028	CORD GRIP 3/4" 90 L-T CONN	1
38	446101	NUT, 3/4 LOCK METAL	1
39	601053	BKT,CP MNT BOTTOM EXHR	2
40	601052	BKT,CP MNT TOP EXHR	1
41	500084	CONNECTOR,PANEL, M12 4 PIN	1
42	601169	THERMOSTATE, SPST HI-TEMP	1
43	446810	STRAIN RELIEF,1/2 .23-.54 GRP	1
44	112510	NUT, 3/4 LOCK METAL	1

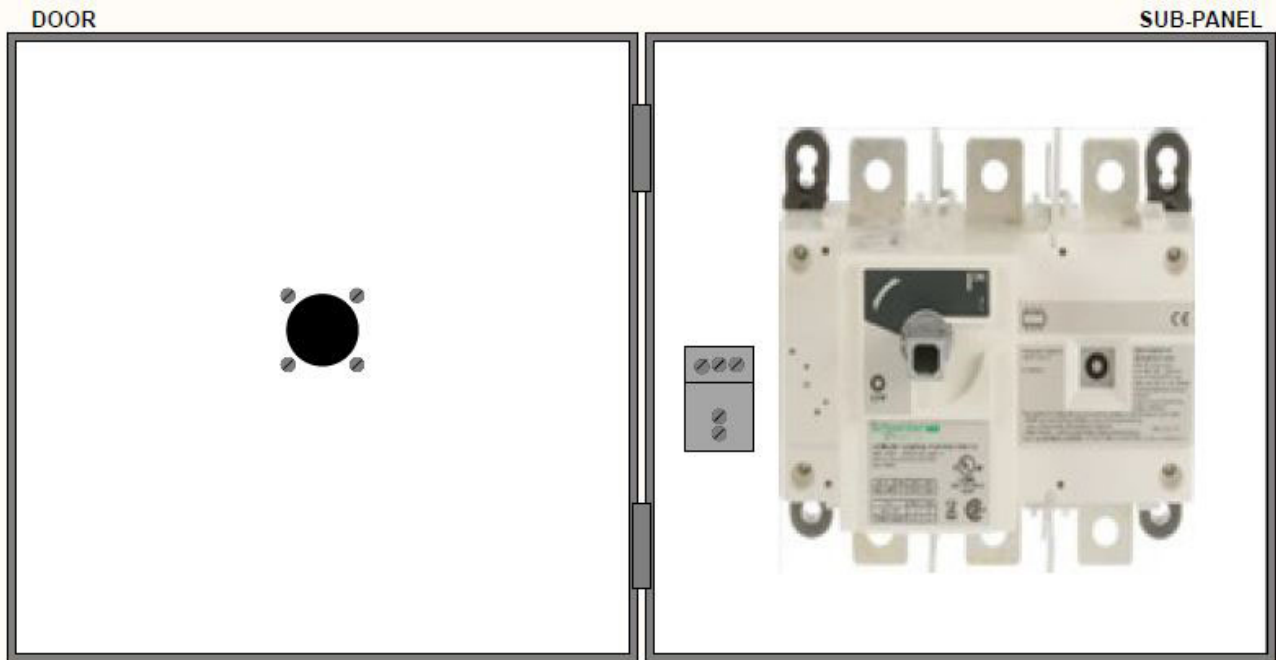

S No.	PART #	DESCRIPTION	QTY
1	E700418	SWITCH.DISCONNECT NO-FUSE200A	1
2	E700419	SHAFT.EXTENSION 100-400A	1
3	E700420	HANDLE.100-400A NEMA 3R	1
4	E700421	SWITCH SHROUD, 100-200 3P TOP	1
5	E700422	SWITCH SHROUD, 100-200 3P BTM.	1
6	E700433	CONNECTOR, LIQ-TITE 2" MTL45D	2
7	E700435	CONDUIT, 2" FLEXIBLE METAL-100'	10 FT
8	E700450	KIT, TERMINAL LUGS #6 KCMIL	1
9	E700427	PANEL BOX, 14"X12"X6"	1
10	601181	CABLE,1/0 DLO-2KV	1

# SCHEMATICS

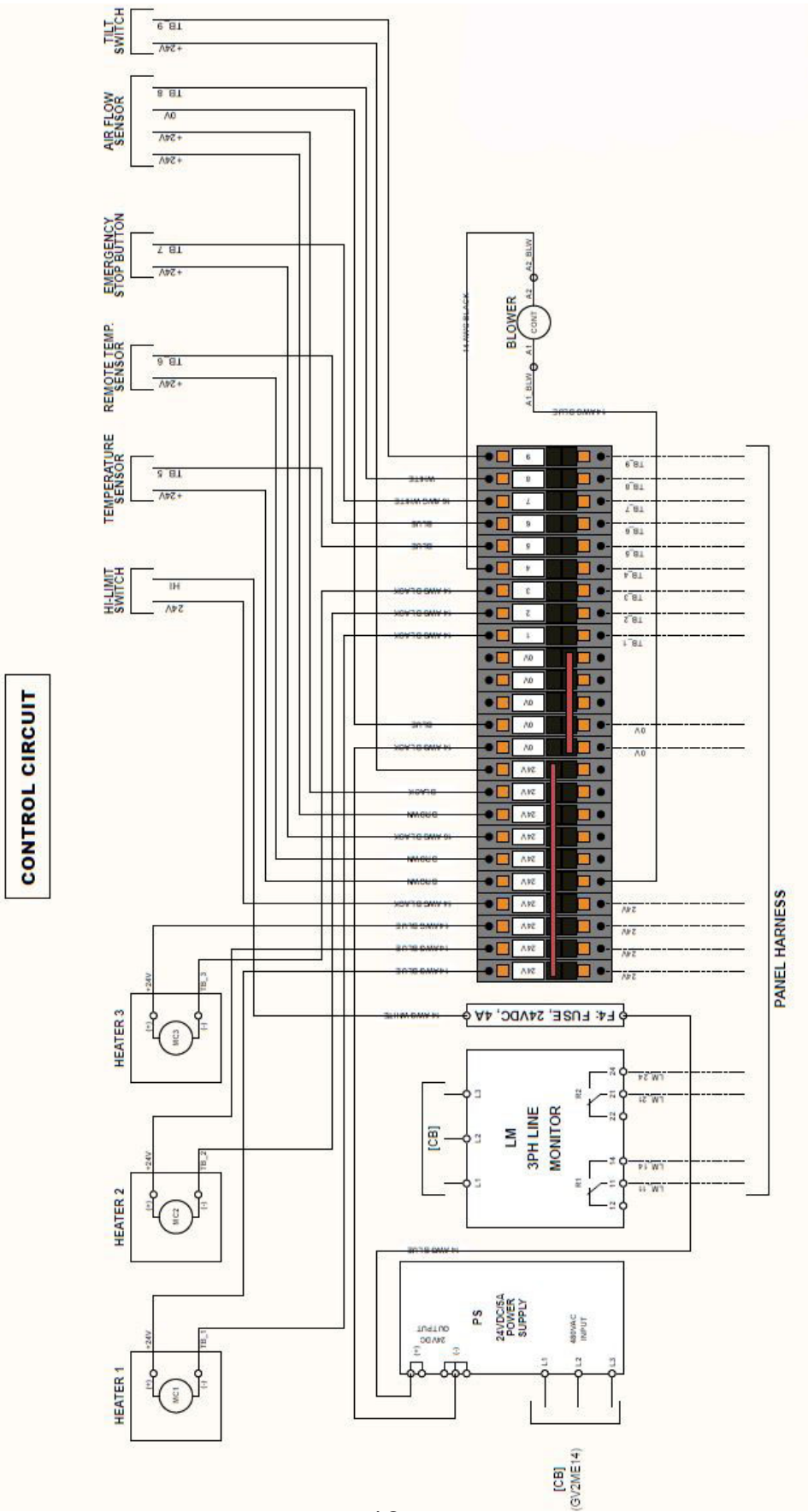

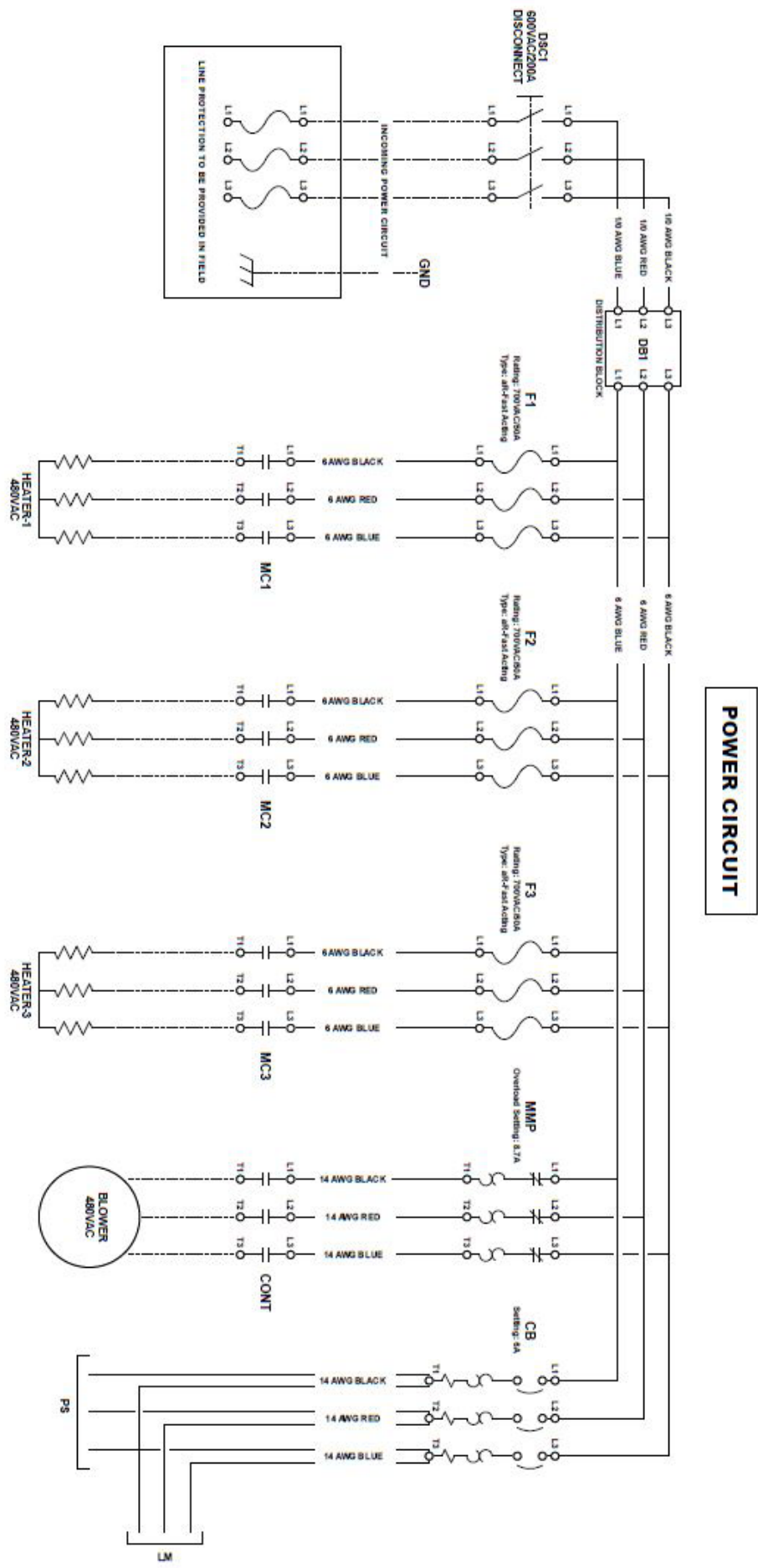

# THAWZALL

Tamarack Industries

2736 Latoka Lane, Unit B  
Alexandria, MN 56308  
USA



[WWW.THAWZALL.COM](http://WWW.THAWZALL.COM)



[support@tamarack-ind.com](mailto:support@tamarack-ind.com)



1-800-661-0304



1-320-759-1583